

Actuator series Driven by Ezi-SERVO

- Compact Linear Ball Screw Actuator with Hollow Shaft Motor
- Space Saving and Reducing Installation time
- Various Field Networks Supported such as EtherCAT, Ethernet, CC-Link, Pulse Input
- High Resolution Encoder (Max. 20,000ppr)
- Size Line-up (□20mm, □28mm, □42mm, □56mm)



Table Type

Name		Unit	CLA20T-01R25	CLA28T-01R30	CLA42T-02R40 CLA42T-08R40		CLA56T-04R50
Lead		mm	1	1	2	8	4
Stroke		mm	25	30	40		50
Ball Screw Type		—	Rolled	Rolled	Rolled		Rolled
Repeatability	Table Tip	mm	±0,01	±0,01	±0,01		±0,01
	Upper		±0,01	±0,01	±0,01		±0,01
Lost Motion		mm	0,05	0,05	0,05		0,05
Linear Travel / Step		mm	0,00025	0,000625	0,0002	0,0008	0,0004
Permissible Moment		N · m	—	—	—		—
Transportable Mass	Horizontal	kg	0,5	4	10	5	50
	Vertical		1	4	10	5	50
Thrust Force		N	15	40	200	50	500
Maximum Speed		mm/s	20	40	50	200	50

Rod Type

Name		Unit	CLA20R-01R25	CLA28R-01R30	CLA42R-02R40 CLA42R-08R40		CLA56R-04R50
Lead		mm	1	1	2	8	4
Stroke		mm	25	30	40		50
Ball Screw Type		—	Rolled	Rolled	Rolled		Rolled
Repeatability	Table Tip	mm	±0,01	±0,01	±0,01		±0,01
	Upper		±0,01	±0,01	±0,01		±0,01
Lost Motion		mm	0,05	0,05	0,05		0,05
Linear Travel / Step		mm	0,00025	0,000625	0,0002	0,0008	0,0004
Permissible Moment		N · m	—	—	—		—
Transportable Mass	Horizontal	kg	1,5	4	40	10	50
	Vertical		1,5	4	20	5	50
Thrust Force		N	15	40	200	50	500
Maximum Speed		mm/s	20	40	50	200	50

■ Dimension (Table Type 42mm)

Model Name	Cable Direction				Option	Installation Plate
	Left	Right	Down	Up		
CLA42T-02R40-□	L	R	D	U	w/ Knob	BRACKET, FLANGE, FOOT
CLA42T-02R40-K□	L	R	D	U	w/o Knob	
CLA42T-08R40-□	L	R	D	U	w/ Knob	
CLA42T-08R40-K□	L	R	D	U	w/o Knob	

Specification	
Motor	HSE-42L-A
Stroke	40 mm
Ball Screw Diameter	Ø6
Lead	2 mm 8 mm
Repeatability	±0,01 mm
Lost Motion	0,05 mm
X Load Capacity	8 kg 6 kg
Y Load Capacity	4 kg 3 kg
Static Rated Moment	Mp : 1,3 My : 1,0 Mr : 2,5 N · m
Material	Body (Aluminum)
Finish Treatment	Black Anodizing (Semi-Gloss)
Max. Speed	20 mm/s 80 mm/s
Grease	AFF Grease

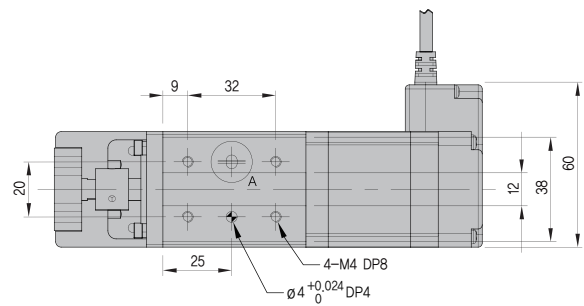
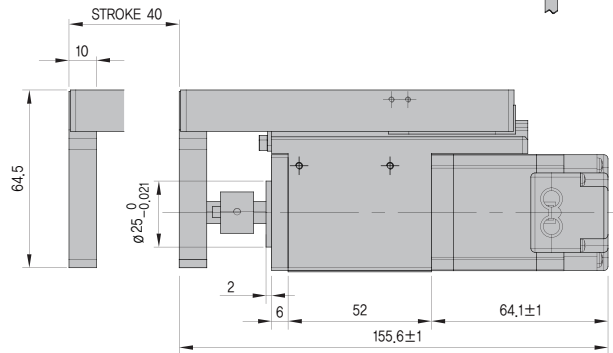
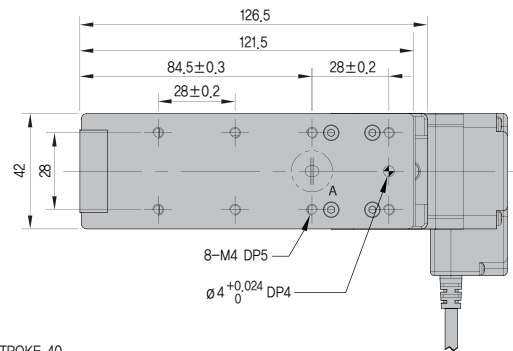
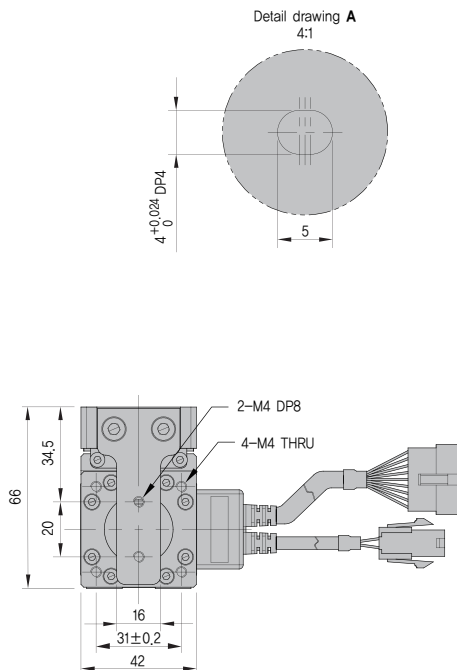

■ Cable Direction (Table Type 42mm)

Left	Down	Right	Up



Fast, Accurate, Smooth Motion

* Product information in this catalog based on date of Sep 2022.
The specification of product can be changed without pre-notification due to enhancements and improvements of product.

FASTECH Co., Ltd.

Rm#1202, 401-dong, Bucheon Techno-Park,
655, Pyeongcheon-ro, Bucheon-si Gyeonggi-do,
Republic of Korea (Postal Code: 14502)
Homepage : www.fastech-motions.com

TEL : +82-32-234-6317
FAX : +82-32-234-6302
E-mail : sales@fastech-motions.com